

System 210
HPL Panel Concealed Rainscreen Attachment System
Standard Details
Revised 06/2016

System 210 Typical Notes:

1. System 210 requires a minimum HPL panel thickness of 10mm.
2. System 210 cannot be installed over 40'-0" in height above grade.
3. A minimum 20% open area continuous vertical ventilation cavity must be present behind the HPL panels.
4. HPL panels cannot be used in conjunction with foam plastic insulation.

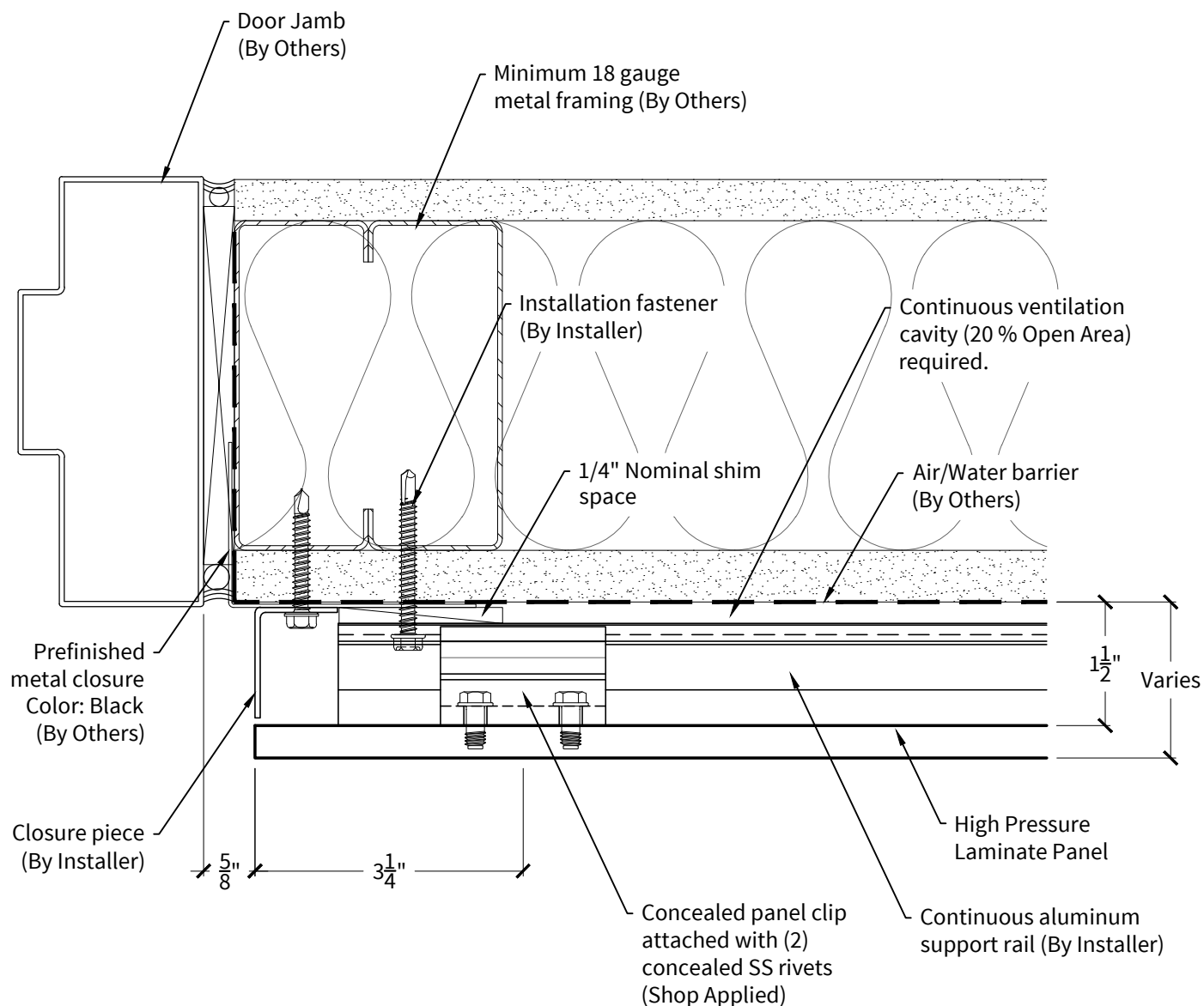

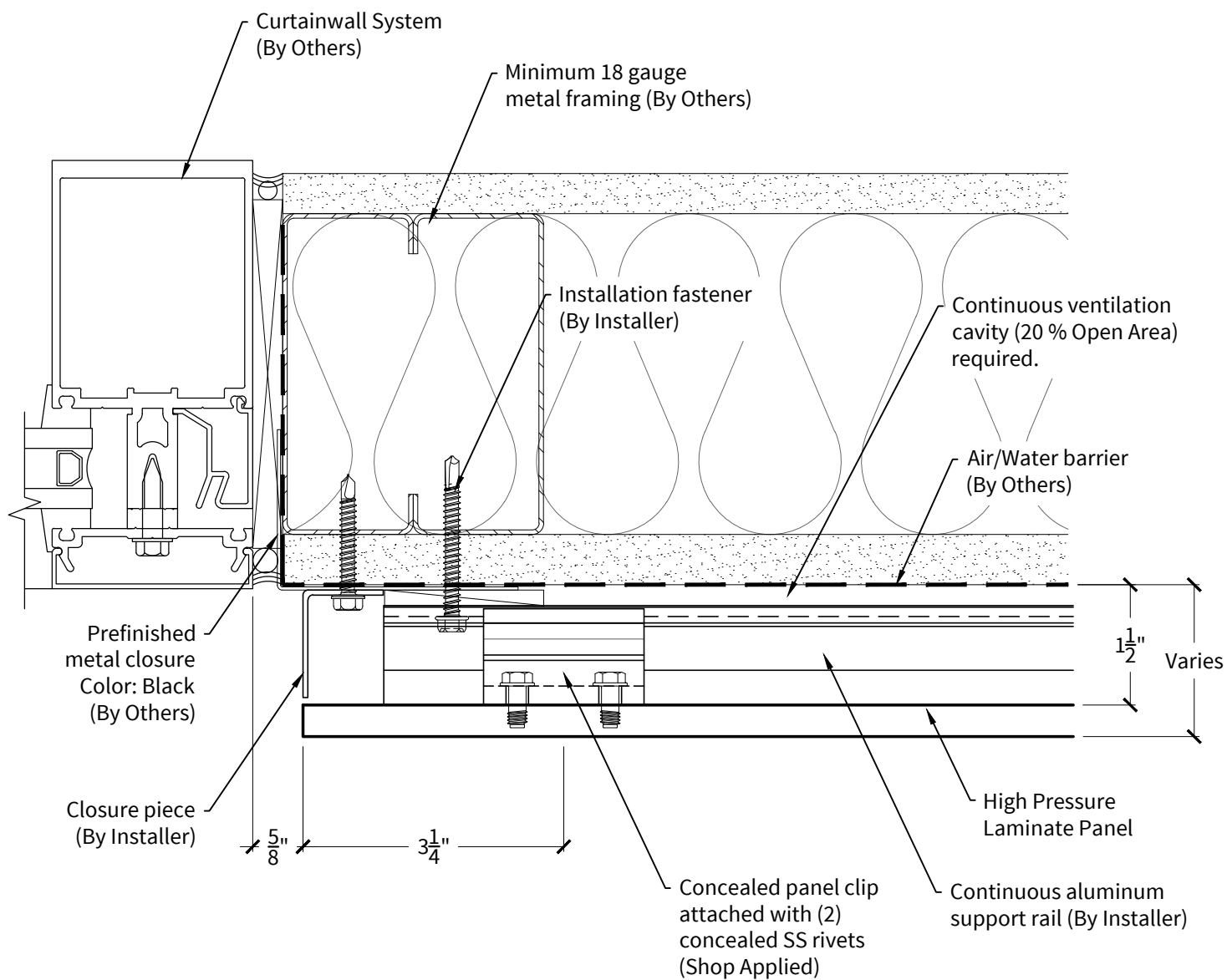

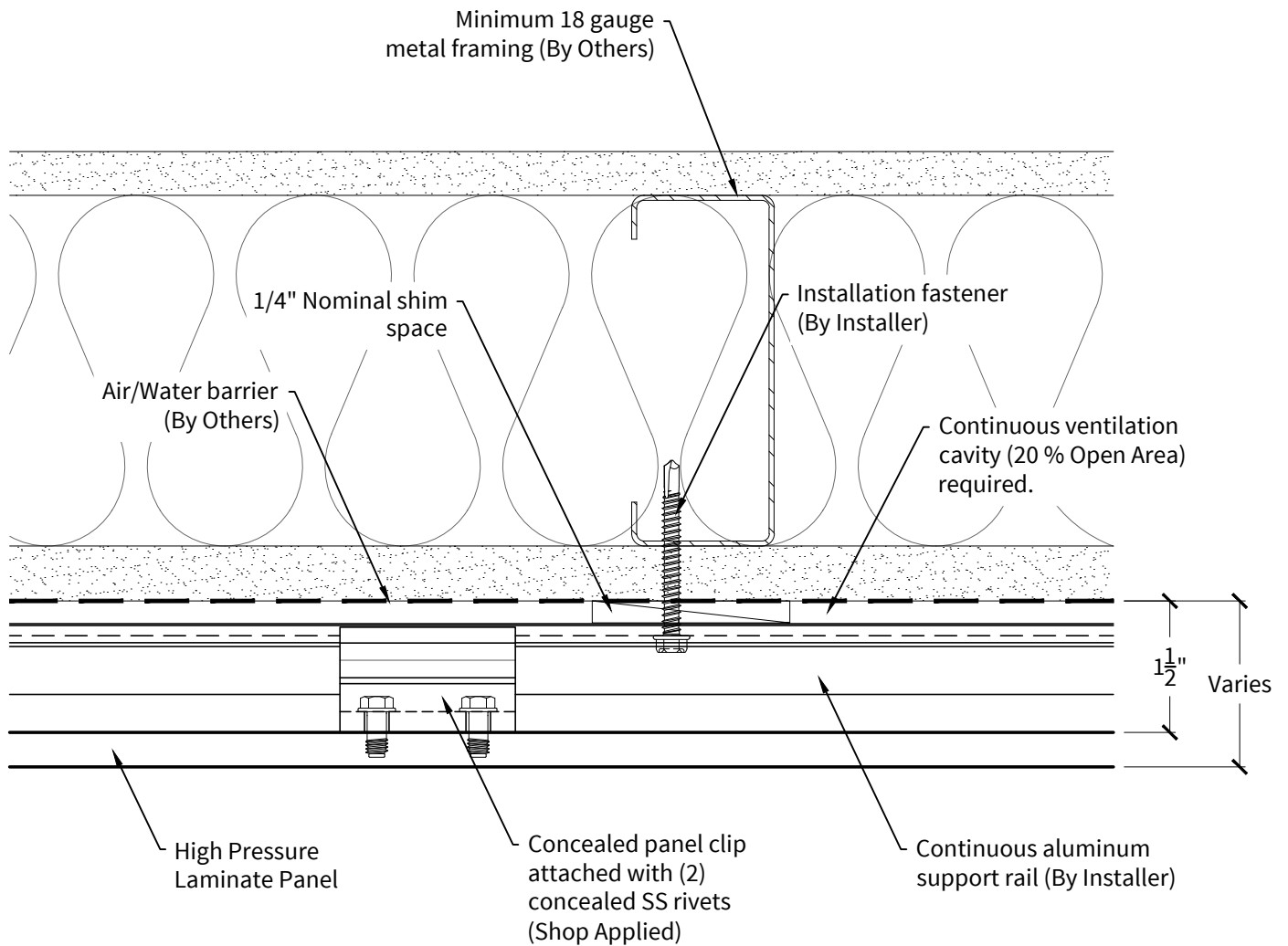

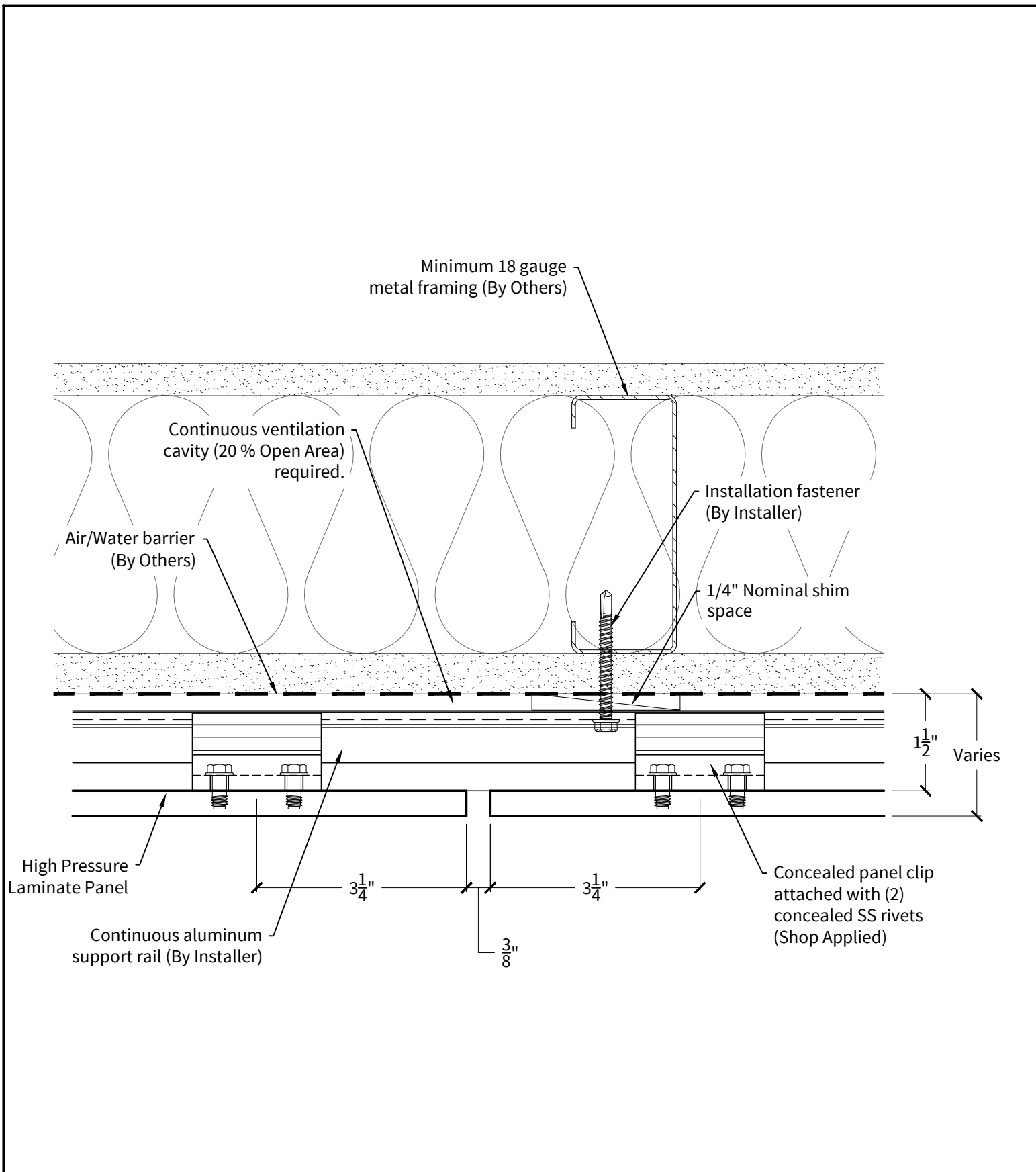

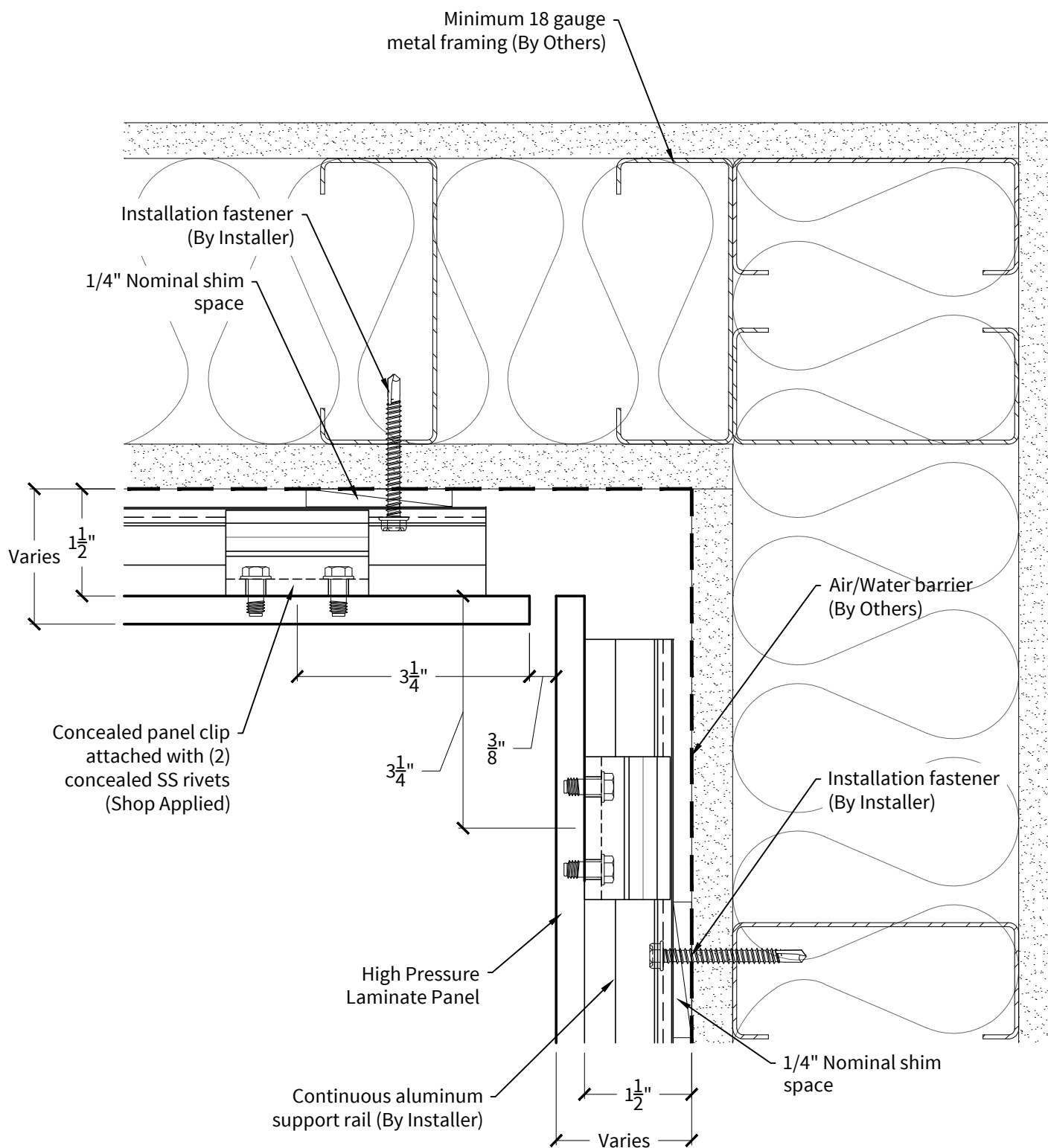

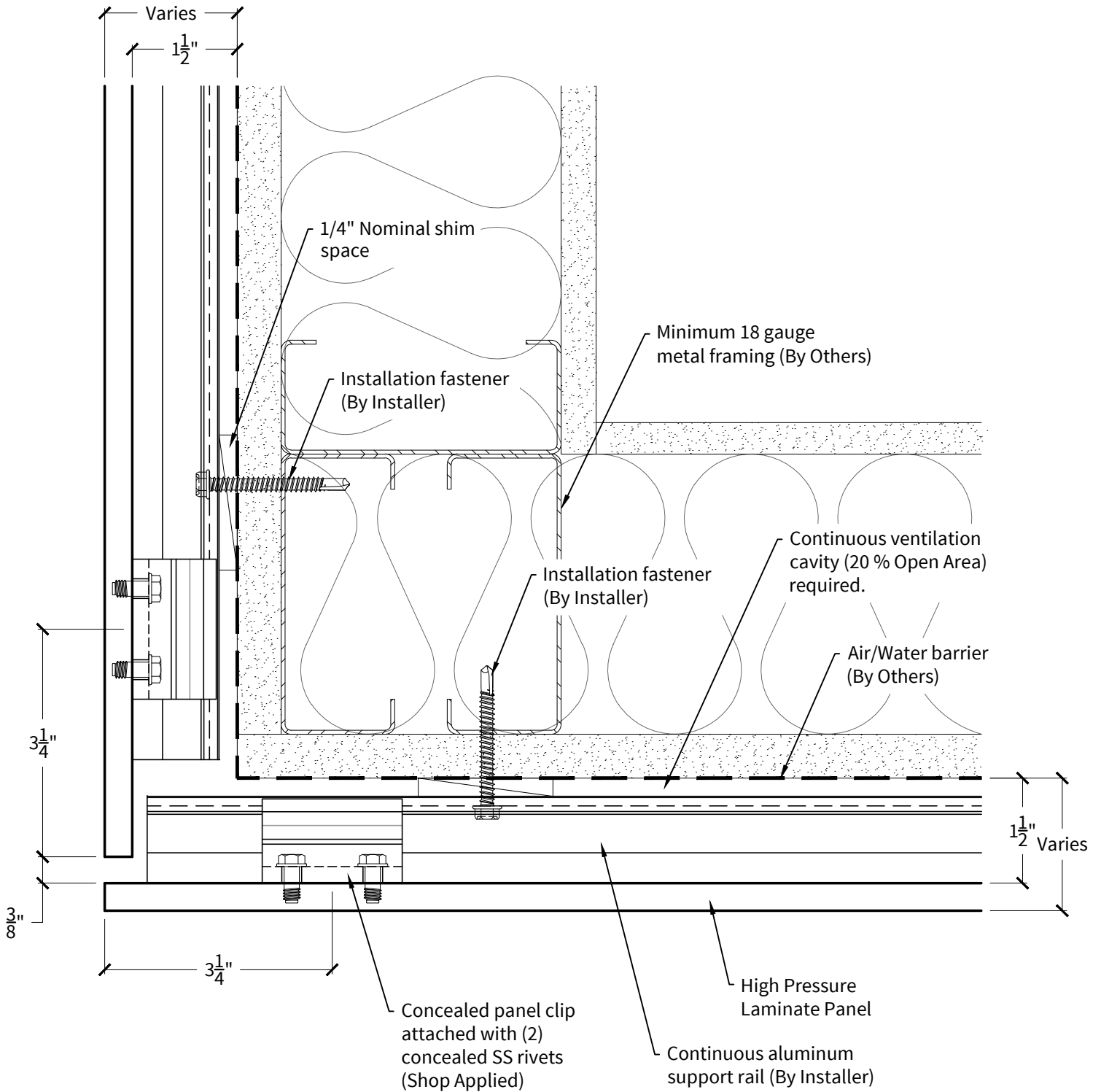



facebook.com/millerclapperton
@thepanelguys

